

FIRST FLOOR:
6, 6198 SF CLUBHOUSE
2,439 SF LEASING OFFICE

SECOND-FOURTH FLOOR:
72 UNITS PER FLOOR
254 UNITS TOTAL

**AVAILABLE
UP TO
6,834 SF**

**PROPOSED
UPSCALE SPORTS
BAR/ RESTAURANT
7,172 SF**

 **STARBUCKS®**
2,004 SF

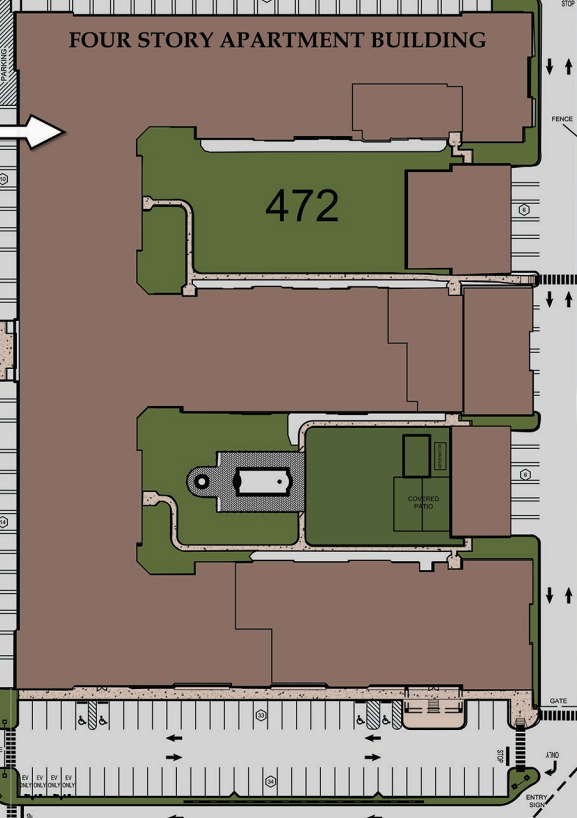

**PAD OPPORTUNITY
UP TO 5,308 SF**

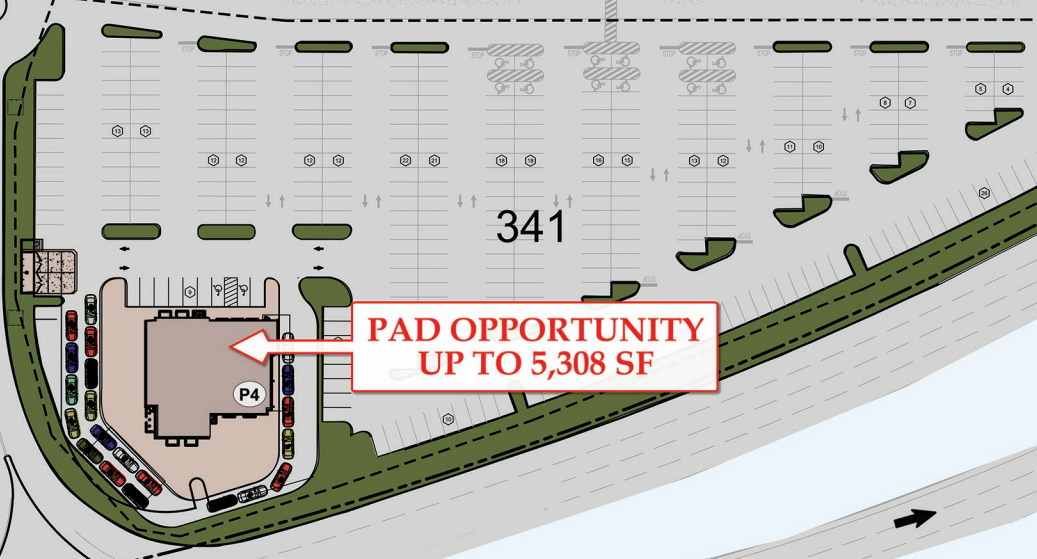

NJ STATE HIGHWAY ROUTE 1 (SOUTH)
NJ STATE HIGHWAY ROUTE 1 (NORTH)

CONCEPT PLAN

**** FOR INFORMATIONAL PURPOSES ONLY. VARIATIONS
MAY OCCUR IN SOME LEASING PLANS. DIMENSIONS
AND SQUARE FOOTAGE ARE APPROXIMATE.**

RARITAN HEIGHTS

11 ROUTE 1 SOUTH, NEW BRUNSWICK, NJ (MIDDLESEX COUNTY)

